



		BS002G
		125 mm
×		40 mm × 760 mm
		190 - 810 m/min (3.1 - 13.5 m/s)
	BL4040	592 mm
		D.C. 36 V - 40 V
		4.0 - 5.2 kg

-
-
-

	BL4020* / BL4025* / BL4040* / BL4040F* / BL4050F* / BL4080F / BL4080H *
	DC40RA / DC40RB / DC40RC / DC40WA / BCC01 / BCC02

-

	/
--	---



	PDC01 / PDC1200 / PDC1500
--	---------------------------

-
-



 Ni-MH
Li-ion

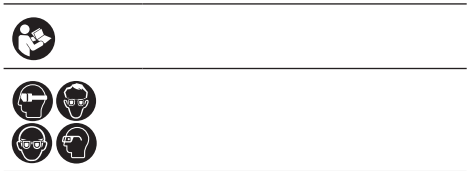



7. EMF



1.



2.

3.

/

“ ”

4.

5.

1.

6.

2.

7.

3.

8.

1.

9.

2.

EN 166
AS/NZS 1336
ANSI Z87.1

3.

4.

5.

6.

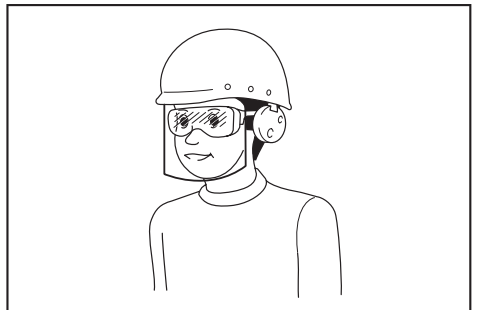

RCD

RCD

1.

2.

3.

4.

5.

6.

7.

8.

9.

1.

2.

3.

4.

5.

6.

7.

1.

2.

3.

1.

2.

3.

4.

5.

6.

7.

8.

9.

/

130





1.

1
3

2

2.

3.

4.

5.

(1)

(2)

(3)

6.

50 ° C 122 ° F

7.

8.

9.

10.

11.

12.

Makita

13.

14.

15.

16.

/

17.

18.



1.











2.

3. **10 ° C - 40 ° C 50 ° F - 104 ° F**

4.

5.



			
			75% 100%
			50% 75%
			25% 50%
			0% 25%
			
 ↑ ↓ 			





" OFF "



" ON "

" ON "

" I (ON) "



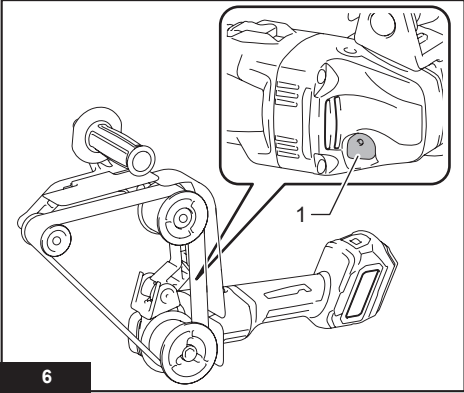

▶ 1.



ON

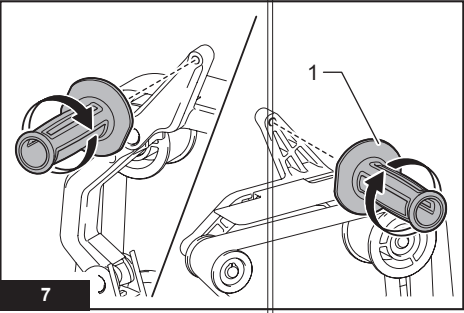

▶ 1.



- 1.
- 2.

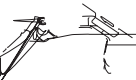
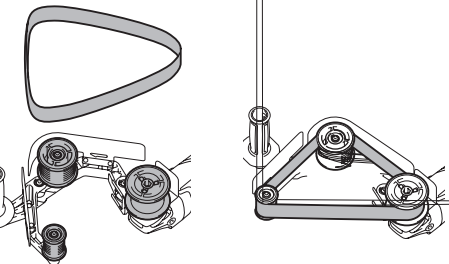
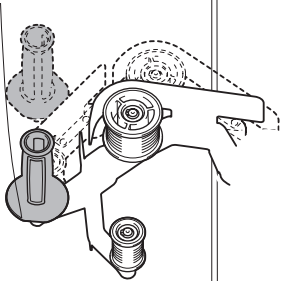

2.





扫一扫
可查询
售后保修条例

亦可登录

<https://www.makita.com.cn/service4.php>

查询售后保修条例

扫一扫
了解更多
产品防伪查询
方

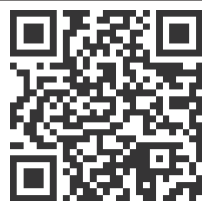

亦可登录

<https://www.makita.com.cn/service5.php>

了解更多产品防伪查询方法介绍

总制造商： 株式会社牧田
日本国爱知县安城市住吉町 3-11-8

www.makita.com